

## Gewinde Aufschraubstutzen DIN 11851

DN	A	B	C	kg	304	316L
					Art. Nr.	Art. Nr.
DN 10	30.00	Rd28x1/8"	G 3/8"	0.05	129000101	129000103
DN 15	30.00	Rd34x1/8"	G 1/2"	0.12	129000151	129000153
DN 20	30.00	Rd44x1/6"	G 3/4"	0.12	129000201	129000203
DN 25	35.00	Rd52x1/6"	G 1"	0.19	129000251	129000253
DN 32	35.00	Rd58x1/6"	G 1 1/4"	0.23	129000321	129000323
DN 40	35.00	Rd65x1/6"	G 1 1/2"	0.30	129000401	129000403
DN 50	35.00	Rd78x1/6"	G 2"	0.36	129000501	129000503
DN 65	38.00	Rd95x1/6"	G 2 1/2"	0.49	129000651	129000653
DN 80	43.00	Rd110x1/4"	G 3"	0.68	129000801	129000803
DN 100	50.00	Rd130x1/4"	G 4"	0.72	129001001	129001003

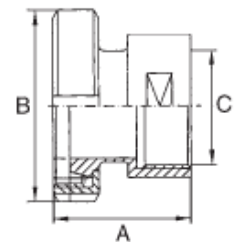

## Kegel Aufschraubstutzen DIN 11851

DN	A	B	C	kg	304	316L
					Art. Nr.	Art. Nr.
DN 10	40.00	38.00	G 3/8"	0.15	130000101	130000103
DN 15	44.00	44.00	G 1/2"	0.20	130000151	130000153
DN 20	45.00	54.00	G 3/4"	0.29	130000201	130000203
DN 25	49.00	63.00	G 1"	0.39	130000251	130000253
DN 32	52.00	70.00	G 1 1/4"	0.49	130000321	130000323
DN 40	53.00	78.00	G 1 1/2"	0.57	130000401	130000403
DN 50	55.00	92.00	G 2"	0.74	130000501	130000503
DN 65	61.00	112.00	G 2 1/2"	1.33	130000651	130000653
DN 80	67.00	127.00	G 3"	1.55	130000801	130000803
DN 100	76.00	148.00	G 4"	2.34	130001001	130001003